

MATERIAL / COLOR	FAMCO PART NUMBER
A - ALUMINUM	WVEB5A
G - GALVANIZED	WVEB5
PL - PAINT LOCK	WVEB5PL
WH - WHITE	WVEB5WH
BR - BROWN	WVEB5BR
BK - BLACK	WVEB5BK

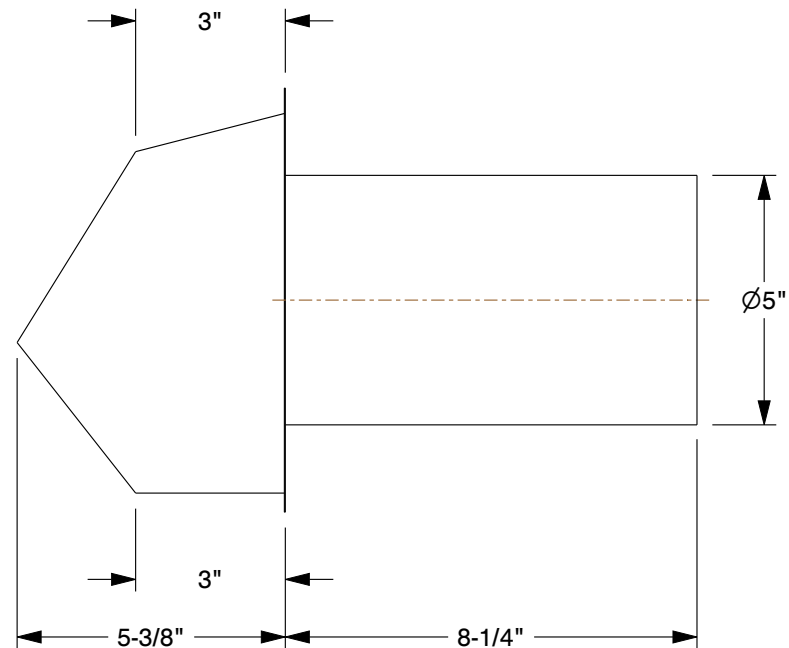

NOTES:

1. QUALITY CONSTRUCTED FROM HEAVY-DUTY 28 GAUGE GALVANIZED STEEL, 0.020 GAUGE ALUMINUM, OR NEW 26 GAUGE PAINT LOCK MATERIAL.
2. FEATURES 1/4 INCH REMOVABLE SCREEN AND SPRING LOADED DAMPER WITH BUILT IN FOAM GASKET.
3. AVAILABLE WITH OR WITHOUT AN 8-1/4" LONG GALVANIZED STEEL TUBE BUILT INTO THE FLANGE FOR WALL MOUNTED INSTALLATION.

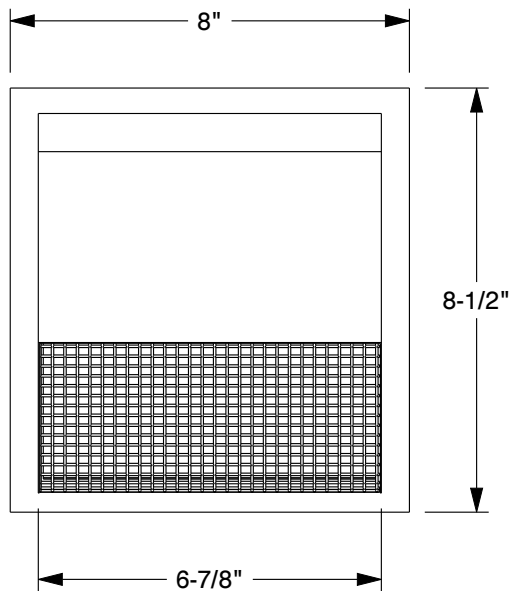

5450 E Franklin Road
#104 Nampa
ID 83687, USA
Ph: 800-234-1903

This file and any associated information and specifications are provided for reference and evaluation purposes only, and is subject to change without notice. FAMCO makes no representations, warranties or guarantees as to the appropriateness, accuracy, completeness, or suitability for any purpose, of the file, information or specifications. You are solely responsible for the use of the file, information or specifications.

**5" BIG MOUTH
HOODED WALL VENTS**
(Refer to the part number mentioned
in the above table)

SCALE	NTS
UNIT	INCH
SHEET	1 of 1